

Shade Structures



YOU WANT IT, WE WILL BUILD IT!



Our experienced team of Designers, Shade Sail Makers & Installers pride themselves on providing vibrant & dynamic designs without compromising on product quality & performance

Contact us for a Free, No Obligation Quote

info@pbhwa.com

Falls Road Primary

- ⇒ Fully Insulated Solarspan Building to be used as Classroom and Storage Area
- ⇒ 7 Walkways
- ⇒ Concrete Pads
- ⇒ Concrete Pathways
- ⇒ Electrical Work (lighting, aircons, data cables)

“The architectural team took our concept and designed a structure which is both visually impressive, has great structural strength and is built with the latest energy saving materials.

The workforce were extremely professional and accommodating. No query was too small or unimportant. They made every effort to work around the needs of the school and the students, taking particular care to minimise noise interruptions by scheduling these activities out of school hours.

The quality of the work is outstanding and where modifications and alterations were needed, these were done in a collaborative, efficient and effective manner.

This project was funded by the school and the P&C and Perth Better Homes were consistently mindful of the need to provide value for money.

The quality of the communication throughout the project was brilliant and I have absolutely no hesitation in recommending Perth Better Homes for future similar projects.”

Kind Regards,

David Ingle
Principle



Piara Waters Primary



Scope of Works

- ⇒ Supply and Install Shade Sails
- ⇒ Circular Sandpit
- ⇒ Excavation
- ⇒ Limestone Retaining Wall
- ⇒ Woodchips to Surrounding Area
- ⇒ Coloured Concrete Pathway

Mulberry

Charcoal

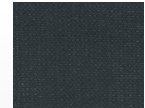

Scope of Works

- ⇒ Supply and Install Shade Structure at the Kiss & Drop
- ⇒ Elevated Skillion Roof Between 2 Transportables
- ⇒ Limestone Steps
- ⇒ Liquid Limestone

Ashdale Primary

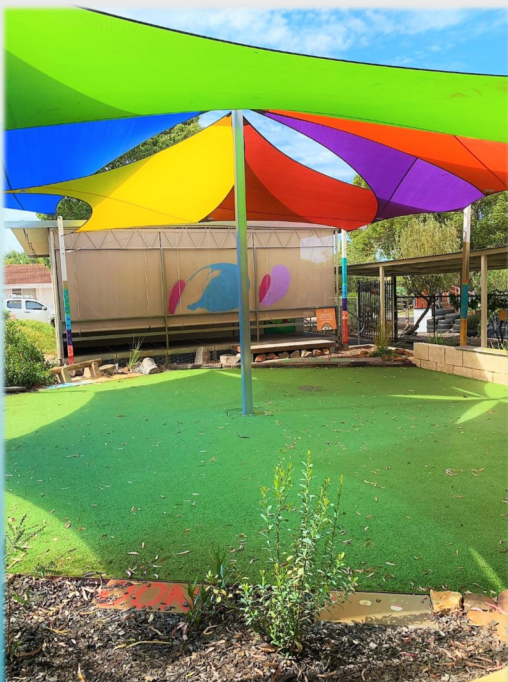
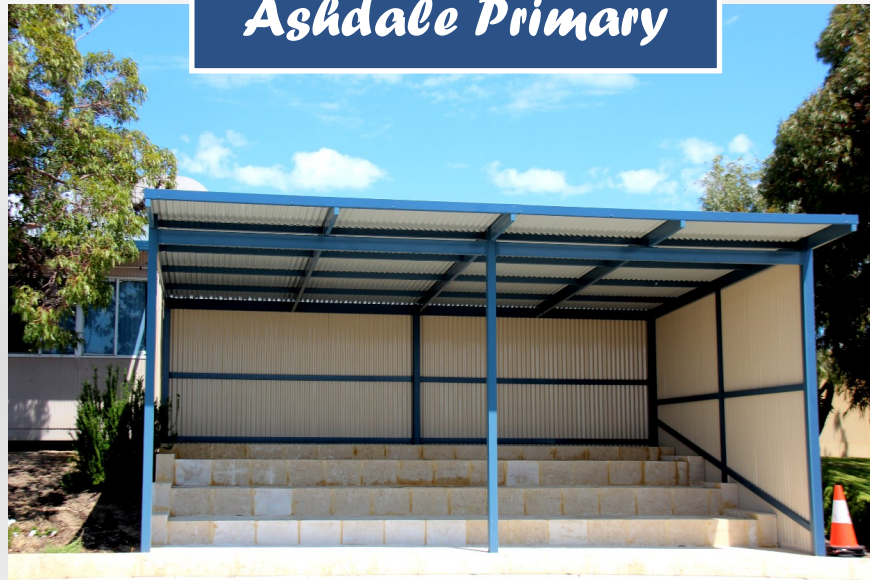

Scope of Works

- ⇒ Supply and Install Shade Sails

Electric
Purple

Zesty
Lime

Atomic
Orange

Laguna
Blue

Sunflower
Yellow

Red
Earth



Ardross Primary

Jellawarra Primary



Scope of Works

- ⇒ Supply and Install Shade Sails incorporating wooden posts
- ⇒ Create Wood Structure in Nature Play Area

Desert
Sand

Terracotta

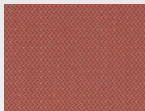
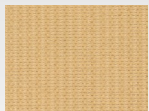

Manning Primary

Scope of Works ⇒ Supply and Install Outdoor “Classroom” using wood



Woodland Grove Primary

Scope of Works

- ⇒ Supply and Install Shade Structure over sandpit
- ⇒ Structure is Hot Dip Galvanized
- ⇒ Limestone Retaining Walls
- ⇒ Link Downpipes to Storm Water



Lakelands Primary

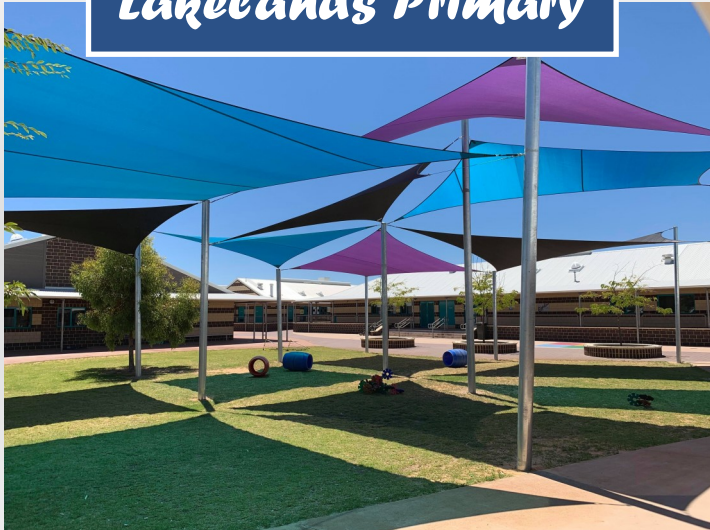

Scope of Works

- ⇒ Supply and Install Shade Sails

Electric
Purple

Black

Laguna
Blue

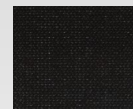
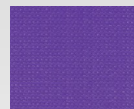

Scope of Works

- ⇒ Supply and Install Shade Sails



Royal Blue



Endeavour Primary

Oberthur Primary



Peter Carnley Anglican Community School

Scope of Works

⇒ Supply and Install Shade Sails



Mulberry

Royal Blue



Scope of Works

- ⇒ Supply and Install Large, Intricate Shade Structure at the Kiss and Drop Area
- ⇒ Supply and Install Gable Roof Structure as an Under Cover Area
- ⇒ Install Internal Walls and Door using Bondor Insulated Panels

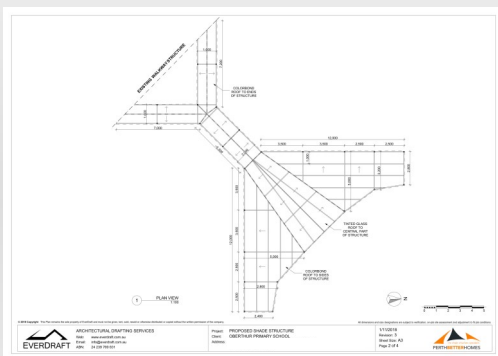
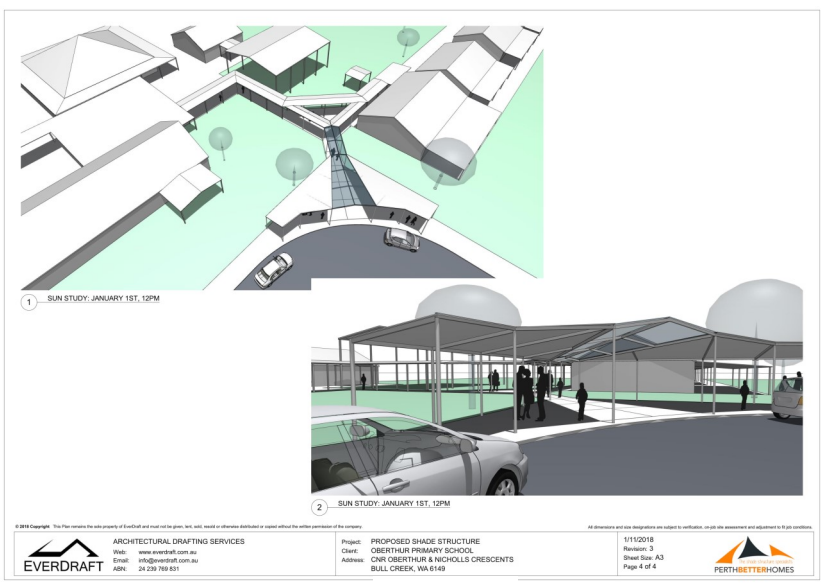
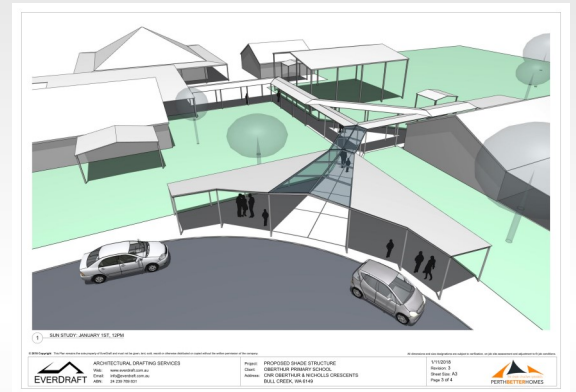
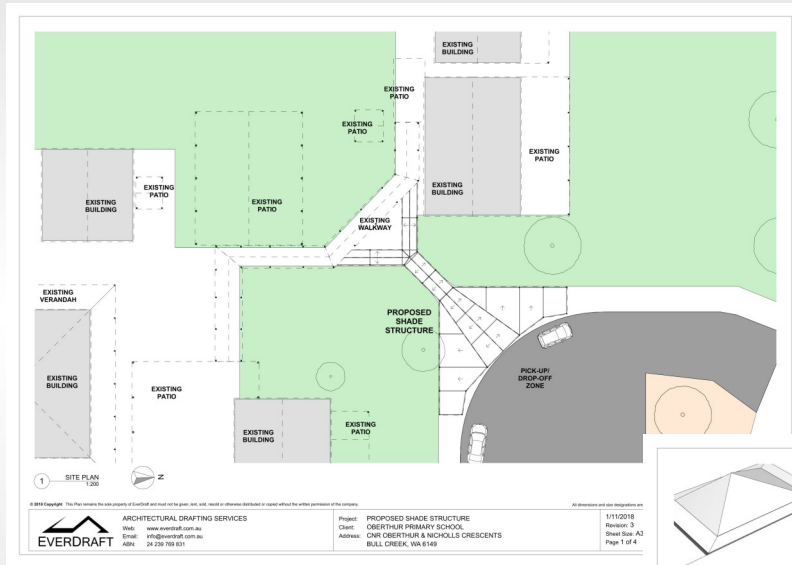

Singleton Primary

Scope of Works

- ⇒ Supply and Install Shade Structure with Deck



Maintenance Program

At Perth Better Homes, we strive to provide top quality services to all our customers. Our Shade Sail Maintenance Program can save you time and money in the future!



- ⇒ Prevent any wear and tear during seasonal weather conditions
- ⇒ Keeps the Shade Sails in great condition
- ⇒ Prolongs the lifespan of your shade sails
- ⇒ Attend to any repairs needed during the winter months



Shade Sail Installation & Removal

Winter Removal

- ◇ Shade Sails shall be taken down during July school holidays or as requested by school

Summer Re-installation

- ◇ Shade Sails shall be re-installed during October school holidays or as requested by school



Aerial Photography

We will use a facility called **Nearmaps** in our office whereby we obtain **specialised aerial photography images of a site** to identify the location of each shade sail and mark with a code, prior to being taken down.



Storage of Shade Sails

The shade sails will be **labelled, bagged and stored** at our work premises during the winter months. We will ensure all shade sails are dry at the time of removal and prior to bagging to prevent the possibility of any mould forming during storage.

Inspection

We will remove all shade sails from bags, prior to re-installation and **carry out a thorough inspection of each shade sail prior to the summer installation of the shade sails.**